

www.pyrexsmokealarms.co.uk

pyrex[®]



PX-1

Smoke Alarm Device

Operating, installation and maintenance manual

Advisory tones

Volume

By activation the device a simple tone is emitted (short: beep).



By pressing the test/stop button a simple tone is emitted (long: beep).



Cause

Activation tone



Test tone



Alarm tones

Volume

Every second a double tone is emitted (short: beep, long: beep).



Every second a simple tone is emitted (short: beep).



Cause

Mute of Alarm tones

Smoke Alert



Each alarm tone can be temporarily deactivated (Smoke Alert and Temperature Alert: 10 min) by pressing the test/stop button (Fig. 1d).

Temperature Alert



10min

Advisory tones

Volume



Every 90 seconds a simple tone is emitted (short: beep).



Every 90 seconds, there is a double tone (short: beep, short: beep).

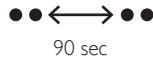

Cause

Mute of Advisory tones

Battery failure signal



Each advisory tone can be temporarily deactivated (Battery failure signal and Contamination Alert: 24 hrs) by pressing the test/stop button (Fig. 1 d).



Contamination of Device Signal

24h



Important: The device has to be replaced (see "Low Battery Signal/ Contamination Signal").

Warranty and European legal guarantee void if broken!

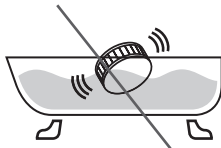

Do not immerse the system in water!

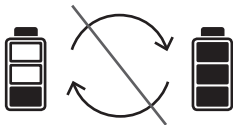

No battery exchange (see
“General safety information”)

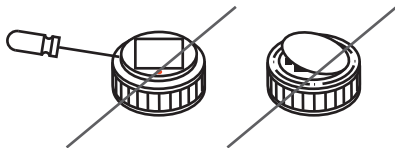

Closed system, only cover is
changeable

How to Deactivate the system

Push cover to turn the signal off



Open the cover

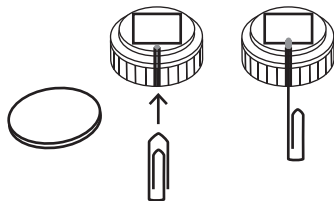
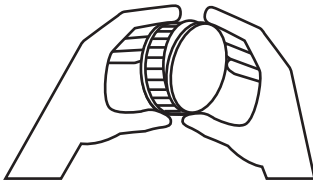

Push red activation button to power off

①

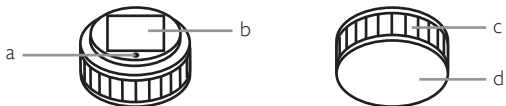

②



③

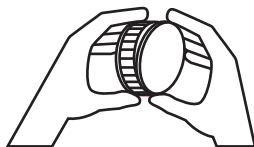

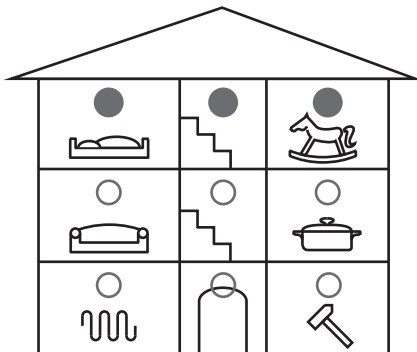

4

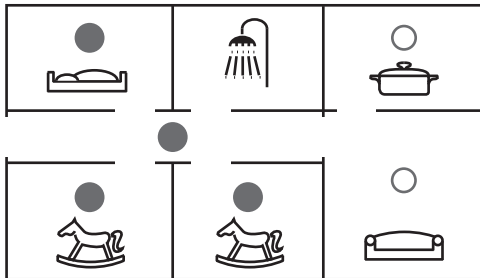

What to do in case of fire?

- Stay calm.
- Warn everyone at the residence.
- Help children, the disabled, the elderly and persons suffering from illness.
- Close all windows and doors behind you.
- Get out of the house immediately.
- Do not use elevators.
- Alert the fire department.

Installation

The smoke alarm device is kept in place by a magnetic holder (Fig. 1b). There are two ways described below to fasten the holder to the ceiling. Please keep in mind that the holder is strongly magnetic only on one side!

Installation with adhesive

Means of anchorage (magnetic holder with self-adhesive coating on reverse side) acc. to EN 14604: 2005/AC: 2008

Caution:

The use of this means of anchorage establishes a very maintenance-friendly, firm, magnetic connection between the device and the installation surface which makes it possible to release the device (for example for testing/maintenance/cleaning) from the magnetic holder by pulling it off vertically.

Only use the adhesive supplied with the product when installing the device with adhesive! The installation location must be solid, dry and free of grease, dust and loose paint etc.

Remove the information sticker, as shown in Fig. 2, and then the protec-

Installation with screw anchor

tive sheet from the adhesive applied on the magnets. Press the magnetic holder firmly for about 10 seconds onto the location chosen for installation. Afterwards, the device can be mounted onto the magnetic holder (Fig. 1b). Should it be necessary, the device can then be pulled off the magnet holder vertically.

The adhesive bond attains its final strength after approx. 72 hours.

Please leave the adhesive on the magnetic holder even when installing with screw and anchor. Drill a hole at the installation site and insert the screw anchor supplied into the hole. Then insert the supplied countersunk screw into the bottom side of the magnetic holder as displayed in Fig. 2, so that the screw is flush with the magnetic holder (Fig. 1b) when screwed into the anchor. To do this, push the screw through the perforated hole. To ensure that the device is securely fastened, the screw has to be completely screwed into the recess of the magnetic holder (Fig. 1b). Please tighten the screw securely, but without deforming or bending the magnetic holder.

Testing and maintenance

The smoke alarm device monitors itself automatically once a minute to check if it is operational. This device also automatically regulates the sensitivity of its optical detection system depending on the environmental effects.

Please make sure that the air vents covering the side of the smoke alarm device remain free of dust, dirt, paint, or tape etc. Otherwise, the operation of the device may be impaired!

To ensure that the device is operational, you should regularly press the test/stop button (Fig. 1d) to set off the test alarm. Do this at least once a month. Please check that the device is not damaged, is mounted securely to the installation site, and that the smoke intake fins (Fig. 1c) remain completely free of foreign

objects. If the acoustic signal is not emitted when you test the alarm, then the device has to be replaced.

Low Battery Signal/ Contamination Signal

If the energy supply of the smoke alarm device is low or the optical detection system becomes so soiled that automatic adjustment is no longer possible, then the device emits a signal alerting you to these conditions (see “Alarm and advisory tones”). This gives you enough time to replace the smoke alarm device. The smoke alarm device is then only capable of sounding its alarm for a maximum of 60 more days. It is imperative to replace the device before this time elapses!

Possible causes for an alarm without fire as the cause

- In some rooms, there is usually more dust than in others. A bedroom is often one such room. Frequently they contain plush carpets; clothing, bed spreads and pillows etc. are often stored in bedrooms and moved around a lot (e.g. shaking).

Drafts in the rooms (e.g. open windows, fans) can lead to small amounts of dust accumulating in the device over time.

- One or more of the following substances have entered directly into the device: steam and vapors from cooking, boiling or frying; air freshener, fragrances, or insect spray; pollen; dust from construction or sanding; fine dust.

- One or more very small insects or other very small organisms have gotten past the insect barriers of the device.

Carefully cleaning the device regularly with a vacuum cleaner helps avoid a false alarm due to soiling.

- Extreme temperature fluctuations or very strong electro-magnetic radiation in the direct vicinity of the smoke alarm device have an effect on the device.
- Cigarette smoke only sets off the alarm when smoke enters the smoke alarm device either directly from the immediate vicinity or due to extremely high concentrations.

To avoid a false alarm from the smoke alarm device due to soiling, the device should be protected against all of the environmental effects mentioned here.

While cooking or if a lot of steam develops near the smoke alarm device,

always ventilate the rooms well. An alarm due to soiling can be turned off by gently pressing the test/stop button (Fig. 1d) and prevented by ventilating the rooms well.

Please inform your neighbors in case of a false alarm due to soiling, so that the fire department is not unnecessarily alerted!

General safety information

Smoke alarm devices help to spot fires early but can neither extinguish fires, prevent the start of fires, nor alert the fire department.

Smoke alarm devices emit an alarm when there is a hazard due to fumes and to call your attention to this hazard.

Despite taking the greatest care in the production of smoke alarm devices, there is the possibility of malfunction, in which case the device may not be able to quickly alert or to alert at all to the possible start of a fire. Always observe the usual precautionary measures for dealing with fire, combustible materials and technical equipment!

This is a self-contained device. Opening or modifying the device results not only in loss of the warranty and the European legal guarantee, but also has the conse-

quence that the device can and must no longer be used as intended! Please do not ever open the device due the risk of injury!

Changing the battery is neither required and nor even possible.

Please protect this device, especially during renovation but also generally, against wetness, cold, heat, fine dust, vapors with oil, nicotine or paint as well as paint supplies such as wall paint, adhesives and all kinds of dirt. During renovation, construction or sanding, the smoke alarm device may be removed from the magnetic holder (Fig. 1b) by lifting it lightly upwards and then stored safely.

After finishing the work, it is vitally important to remember to place the smoke alarm device back on the magnetic holder (Fig. 1b).

Decoration

Please always observe the following: Only when the device is located at its intended installation site, unsoiled, undamaged and activated is it able to perform its potentially life-saving task of signaling alarm.

The smoke alarm devices test/stop button (Fig. 1d) is removable (Fig. 3) and can be decorated to match the design of the room. Please decorate exclusively this removable surface of the device and never any of its other areas. Afterwards, please refasten it to the device.

Caution! The smoke intake fins (Fig. 1c) on the side of the device must always be kept clear of obstruction and may never be blocked!

The identification plate of the device is found under this easily removable cover.

Intended use

Use this device exclusively for the purpose it was designed and built for! Any other application is not as intended!

This device may only be used for the following purpose(s):

- Detection of fire or smoke in private households
- This smoke alarm device comes with heat warning functionality. It is however not a heat detector according to EN 54-5.

The installation and use of this device in habitable recreation vehicles (e.g. travel trailers) has not been tested.

Service life of the device

After 12 years at most, the end of the service life of the device will have been reached. Please replace the device.

CE conformity

This product has been tested and certified according to the Construction Products Regulation (EU) No 305/2011 (CPR) under the terms of EN14604:2005/AC:2008 as a building product. Production is monitored by regular and independent inspections of consistent compliance with legal and regulatory requirements. Reference number for the declaration of performance: co_1055

EN 14604:2005/
AC:2008



1772-CPR-9308



Service

The PX-I is produced by Pyrex Technologies GmbH.

pyrex.com/en/support

Disposal

According to the EU's Restriction of Hazardous Substances Directive, this product may not be disposed of in household garbage. Please send the device back to the manufacturer for recycling or give it to the waste management company responsible for this in your area. Please keep in mind that improper disposal can harm the environment.

12 years limited warranty

Pyrex Technologies GmbH provides a warranty to the original buyer only, for the duration of 12 years starting from the date of purchase, that this product, which was either purchased from Pyrex Technologies GmbH directly or from an authorized reseller, is free from defects when used as intended and maintained under intended conditions.

This limited warranty is non-transferable and is not valid for buyers, who have purchased the product from a reseller that has not been authorized by Pyrex Technologies GmbH. This also applies to Internet purchases, but is not restricted to them. Rights resulting from legal regulations are not affected by this limited warranty.

Please store the receipt as proof of the purchase date. This receipt is always required for all warranty claims! The limited warranty is only granted if the product is used as described in the instructions for use included with this limited warranty.

This limited warranty does not cover claims which arise from accidents, misuse, application errors, negligence, or those that are caused by the warranty exclusion criteria described in the following.

Warranty exclusion criteria

Soiling:

Dust deposits and insect infestation in the sensor system of the smoke alarm device are not covered by the warranty. Smoke alarms or alarms due to soiling associated with such forms of soiling, which may result from dust deposits or insect infestation in the sensor system of the smoke alarm device, do not indicate a malfunction of the device, they only indicate a lack of care, cleaning, and maintenance of the device.

Physical / mechanical damage:

If the smoke alarm device is damaged, or for example, the casing is broken or the device has been opened, it leads to the loss of all warranty claims. The same applies to any use of force on the device, which causes interior damage of the smoke alarm device (e.g. electronics) even if the exterior shows no sign of damage.

Contamination:

If the smoke alarm device is contaminated externally and/or internally by adhesions (excessively soiled), it leads to the loss of all warranty

claim. Paints and similar substances on the surface of the device and inside the casing/sensor system of the smoke alarm device are considered contamination. In addition, adhesions such as fire residues (e.g. soot), nicotine and grease deposits, which have led to the obvious discoloration of the device, are also categorized as a contamination, and lead to the loss of all warranty claims. Especially nicotine and grease condensate are not only deposited onto the exterior surface of the device, but also onto the surfaces of the optical sensor components of the smoke alarm device. Particularly there, the adhesion of condensates leads to the premature impairment of the optical properties of the sensor components, which the smoke alarm device can only compensate by means of autonomous recalibration within the physical limits.

Moisture damage / corrosion:

If the smoke alarm device, and particularly its electronics, is damaged by moisture of any kind, it leads to the loss of all warranty claims. Moisture is not only the exposure to a fluid, but also the constant exposure of the device to excessive air humidity (> 70%), because

exposure to excessive humidity (e.g. steam/cooking vapor) drains the battery on the one hand, thus significantly shortening the battery life. On the other hand, fluids and high humidity can damage the electronics of the smoke alarm device by causing corrosion.

Thermal damage:

If the smoke alarm device is exposed to a temperature below 0°C or above 70°C briefly or constantly, it leads to the loss of all warranty claims. In particular, no warranty is given for devices that were exposed to high temperatures and flue gases during a fire. Damage to the device resulting from frost/cold, are not covered by the warranty, the same as heat damage.

Disclaimer

With the exception of the limited warranty described herein, Pyrexx Technologies GmbH assumes no additional explicit or implicit liability under the applicable statutory provisions. This is also valid for any liability related to the merchantability and/or fitness for a specific purpose within the limits of any implied liability that nevertheless exists as a result of legal provisions, the warranty services are limited to the duration of this warranty.

Limitation of liability

Your warranty claims are limited to services related to the repair or replacement of this product as shipped. Pyrexx Technologies GmbH assumes no liability for any special, incidental or consequential damages, including, but not limited to any resulting loss of revenue, loss of profits, restrictions on the use of software/hardware, loss or recovery of data, costs resulting from substitute equipment, downtimes, property damage and claims by third parties, resulting from i.e. the warranty, contractual, statutory, or tort recovery claims, regardless of any other limited or legal implied warranty, or in the event that the limited warranty does not apply, the liability of Pyrexx Technologies GmbH is limited to the purchase price of the product.

pyrexx
smoke alarms

Tel: 0844 800 0841

Email: sales@hardwaresolutions.co.uk

www.pyrexsmokealarms.co.uk